

Confidence in your water quality analysis. Anytime. Anywhere.

Hach® Mobile Sensor Management provides clarity through easy access to crucial information, helping you manage your process and be proactive in your maintenance.



Guidance through actionable sensor information

Focus on your highest priorities, avoid unexpected downtime and reduce maintenance costs with access to actionable information and proactive notifications about maintenance needs.

Simple maintenance instructions in the palm of your hand

Perform instrument maintenance quickly and accurately by following step-by-step instructions on your mobile device.

Alignment of process and laboratory measurements

Verify and adjust process instrument measurements using laboratory reference values with the tap of a finger.

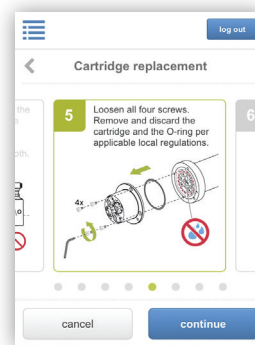
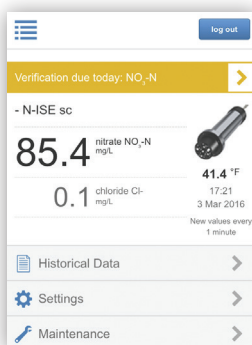
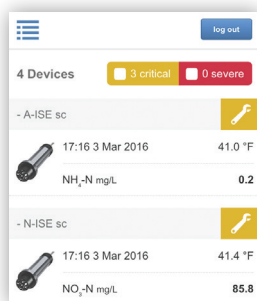

Principle of Operation

Mobile Sensor Management web-based software provides access to the enrolled Hach analytical instrumentation (1) through any Internet-enabled device ("peripheral device") with a standard Internet Browser (2).

All access to the Mobile Sensor Management Web Server (3) is controlled by secure authentication. The status information provided gives an overview of the performance of each individual analytical instrument. It also provides specific information about upcoming maintenance activities for each instrument.

Maintenance procedures can be started easily from the dashboard of the Mobile Sensor Management software. Interactive and step-by-step guidance through the various maintenance steps allows for quick and accurate execution. Integrating Hach's DR3900/DR6000 Spectrophotometer (4) enables simple and convenient verification and calibration of the analytical instrumentation (1).

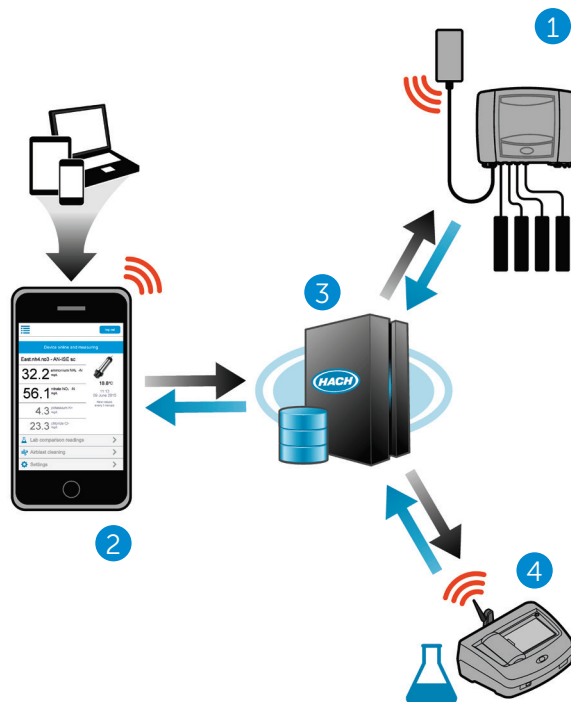

The communication between the Hach instruments seen in (1) and (4) is established through Wi-Fi or a 3G/4G modem.

System Components

Compatible instruments:

- SC1500
- SC4200c
- pH D sc
- 3798-S sc
- Uvas sc
- Sonatax sc
- Amtax sc
- AN-ISE sc
- A-ISE sc
- N-ISE sc
- LDO 2 sc
- Phosphax sc
- Phosphax sc LR
- Solitax ts-line sc, hs-line sc
- Nitratx sc
- DR3900
- DR6000
- TU5300/TU5400sc
- TSS sc

Be confident with Hach Service

Start-Up/Commissioning: Our service technicians visit your site and setup instrumentation, provide basic end-user training on operations and maintenance, and validate settings and performance to get you started.

Service Agreement: Hach provides on-site and in-factory repair, preventive maintenance, and calibration programs for your instruments to ensure reliability and instrument up-time. We have services to fit your specific needs.

HACH World Headquarters: Loveland, Colorado USA

United States: 800-227-4224 tel 970-669-2932 fax orders@hach.com

Outside United States: +1-970-669-3050 tel +1-970-461-3939 fax int@hach.com

hach.com

©Hach Company, 2019. All rights reserved.
In the interest of improving and updating its equipment, Hach Company reserves the right to alter specifications to equipment at any time.

